

Gateforth Park

Residential Park Homes
for the Over Fifties

Affinity 42' x 20'
from **£178,250**



01423 323190 / 07866 225187
gateforthpark@yhlparcs.co.uk
www.gateforthpark.co.uk

 Prestige Homeseeker

As part of our ongoing development, we reserve the right to change or alter specifications without prior notice. Photographs are indicative only and may show features which are not standard E&OE.



Master Suite features a 5ft (Kingsize) double bed

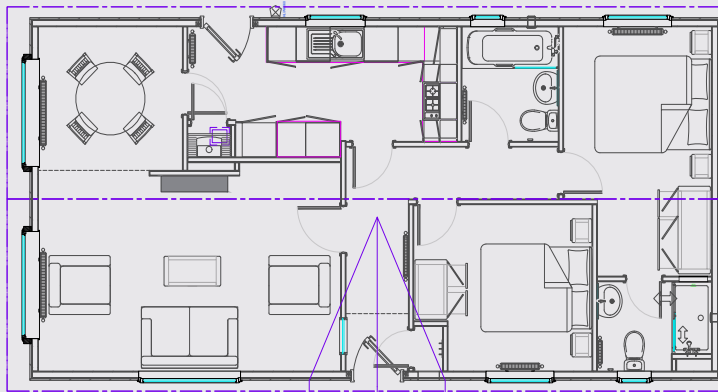

Floor plan for illustration only



KEY FEATURES:

- Colour co-ordinated sofa, curtains and carpets
- Fully fitted kitchen with four burner gas hob, built under oven, dishwasher, fridge/ freezer and washer dryer
- Dining table including four chairs and coffee table
- Freestanding bedroom furniture and en-suite to master bedroom
- Energy efficient A Rated boiler
- Built to British Standard 3632 and protected by a 10 year structural warranty



01423 323190 / 07866 225187 gateforthpark@yhlparcs.co.uk www.gateforthpark.co.uk

Gateforth Park
Residential Park Homes
for the Over Fifties