

Gateforth Park

Residential Park Homes
for the Over Fifties

Avanti 40' x 20'
£168,750

01423 323190 / 07866 225187
gateforthpark@yhlparcs.co.uk
www.gateforthpark.co.uk

 Prestige Homeseeker

As part of our ongoing development, we reserve the right to change or alter specifications without prior notice. Photographs are indicative only and may show features which are not standard E&OE.



Master Suite features a 5ft (Kingsize) double bed

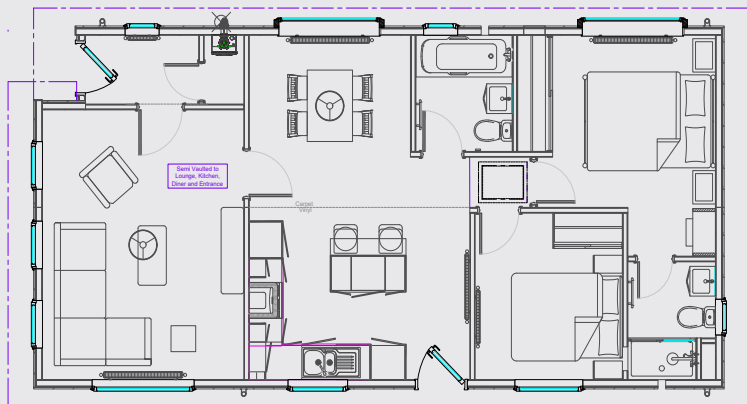

KEY FEATURES:

- Fronted entrance
- Coloured co-ordinated sofa, curtains and carpets
- Fully fitted kitchen and bedroom furniture with walk through wardrobe & en-suite
- Four burner gas hob, eye level oven, dishwasher, fridge/freezer and washing machine
- Dining table including four chairs, coffee table & tv cabinet
- Energy efficient A Rated boiler
- Built to British Standard 3632 and protected by a 10 year structural warranty



01423 323190 / 07866 225187 gateforthpark@yhlparcs.co.uk www.gateforthpark.co.uk

